

System Description

System Connectors (Dash and Floor)

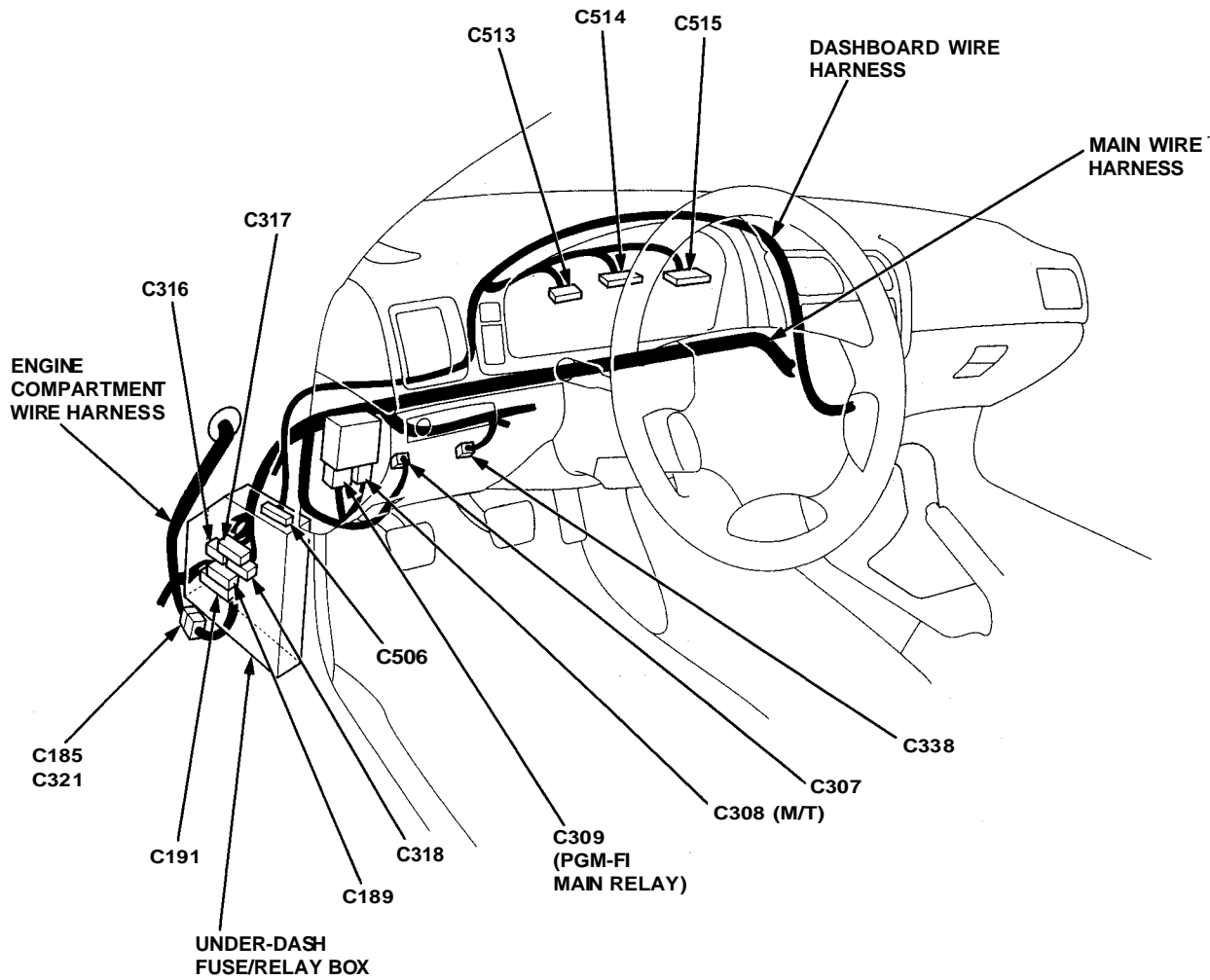



C189



①	WHT/BLK
2	---
③	WHT

C191

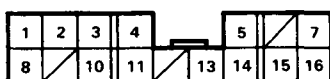

1	YEL/WHT	9	---
2	GRN/YEL	10	GRN/RED
3	YEL/BLK	11	BLU
4	YEL/BLK	12	---
5	YEL/BLK	13	YEL/GRN
6	---	14	YEL/BLK
7	WHT/YEL	15	YEL
8	GRN/BLU	⑩	BLK/YEL

C307 (M/T)



①	BLK
②	PNK

C308

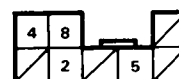

①	YEL/BLK	⑤	BLK/YEL
②	BLK ¹	⑥	BLK/YEL
③	YEL/BLK	⑦	BLK/YEL
④	BLK/WHT	⑧	GRN/BLK

C309



C316



1	---	7	BLK/YEL (A/T)
②	YEL/BLK	⑧	BLK/YEL
3	---	⑨	BLK/YEL
4	YEL (M/T)	10	YEL
5	---	⑪	BLK/YEL
6	YEL/GRN	12	YEL/RED

C317



1	WHT/BLK	8	WHT/BLU
2	RED/WHT ^{*1}	9	---
3	BLU/BLK	10	---
④	BLK/WHT	11	---
5	BLK/RED	12	BLK/WHT
6	GRN/RED	⑬	BLK/WHT
⑦	YEL/BLU	14	RED/BLK

C318



1	BLK/GRN	④	BLK/YEL
2	BLK/WHT	5	BLK
3	---	6	BLK/YEL

C321

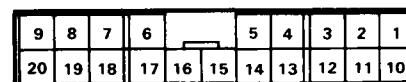

1	BLU/RED	11	BRN/BLK
2	BRN	12	BRN/WHT
3	RED/BLK	⑬	LT GRN ²
4	BLU/RED	14	RED/BLK
⑤	WHT/GRN	15	WHT/BLK
6	RED/GRN	16	WHT/GRN
7	BLU/RED	17	GRN/BLU
8	RED/BLU	18	BRN
9	RED/YEL	19	WHT/BLU
10	RED/BLU	20	YEL/RED

C338



①	WHT/GRN
2	GRY
3	LT GRN
④	GRN/WHT ¹

C506

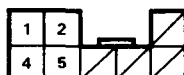

1	YEL	5	YEL/RED
②	YEL	6	---
3	---	7	---
4	BLK/YEL	8	---

C513

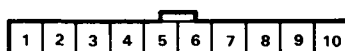

1	GRN/RED	⑥	BLU
2	BLK/WHT	7	BLK/YEL
3	BLU/YEL	8	RED/YEL
4	YEL/RED	9	GRN/BLU
5	WHT/BLU	10	RED/BLU

C514



1	YEL	12	GRN/YEL (A/T)
2	BLK	13	GRN/BLU (A/T)
3	YEL/RED	⑭	GRN (A/T)
4	RED/BLK	15	YEL/GRN (A/T)
5	RED	16	YEL/RED (A/T)
6	BLU/BLK	17	GRN/RED (A/T)
7	---	⑮	GRN/WHT (A/T)
8	BLU/WHT ^{*3}	19	---
9	---	20	---
⑮	LT GRN (A/T)	21	GRN/RED
11	GRN/ORN (A/T)	22	YEL/WHT

C515

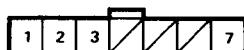

1	BLK
2	BLU
③	YEL
4	---
5	---
6	---
7	GRN/YEL

NOTE: Different wires with the same color have been given a number suffix to distinguish them (for example, YEL/BLK¹ and YEL/BLK² are not the same).

○: Related to Fuel and Emissions System.

*1: Canada model

*2: L, LS model

*3: GS model

(cont'd)

System Description

System Connectors (Dash and Floor)(cont'd)

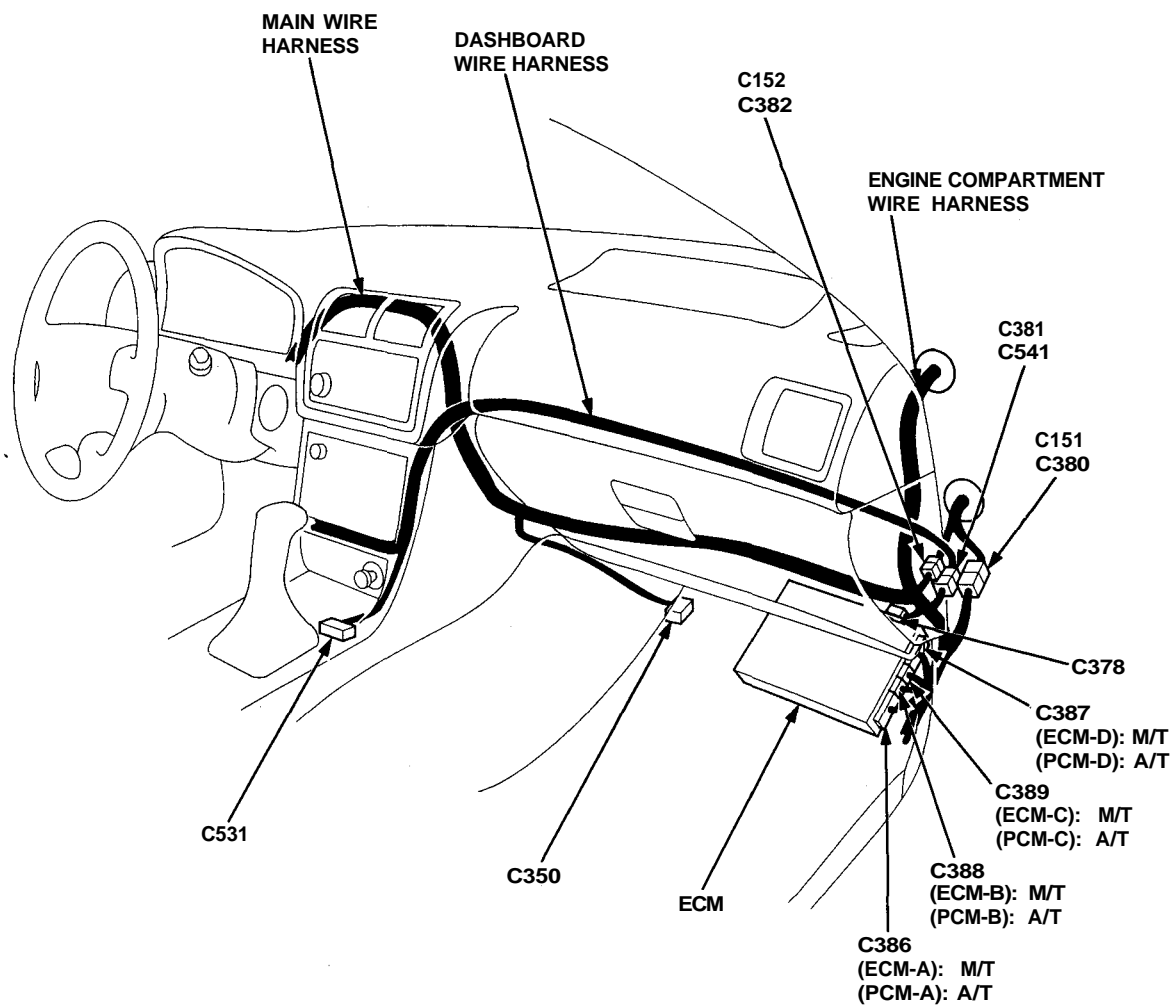



C350

1	2	3	4	6
7	9	11	12	

1	BLU/GRN	7	BLU/WHT
2	BLU	8	---
3	LT BLU	9	BLU/YEL
4	BLK	10	---
5	---	11	BLU/BLK
6	RED/BLU	12	YEL/BLK

C378

1	2
---	---

1	WHT
2	BLK

C380

9	8	7	6	5	3	2	1
20	19	18	17	15	14	13	12

1	YEL ²	11	BLU/WHT
2	RED/BLU ¹	12	BLU
3	PNK	13	RED
4	---	14	BLU/RED
5	GRY	15	GRN
6	BRN ²	16	---
7	BLU/RED	17	BLK
8	RED/BLU	18	PNK
9	LT BLU	19	GRN/BLK
10	BLU/GRN	20	GRN

C381

9	8	7	6	5	4	3	2	1
20	19	18	17	16	15	14	13	12

1	BLU	9	BLK
2	WHT/YEL	10	GRN/WHT
3	BLU/RED	11	BLU/RED
4	RED/YEL	12	GRN/RED
4	RED/GRN ^{*1}	13	BLU
5	YEL/GRN	14	LT GRN (A/T)
6	WHT/BLU	15	YEL/RED (A/T)
7	RED/GRN	16	YEL/GRN (A/T)
7	BLU/WHT ^{*3}	17	YEL/RED
8	BRN/BLK	18	YEL/WHT
8	RED/GRN ^{*3}	19	GRN/RED
		20	PNK

C382

1		
5	4	3

1	BLU/WHT
2	---
3	BLU
4	GRN ²
5	GRY

**C386 (ECM-A): M/T
(PCM-A): A/T**

25	23	21	19	17	15	13	11	9	7	5	3	1
26	24	22	20	18	14	12	10	8	6	4	2	

1	BRN ¹	14	RED/BLU ¹
2	WHT/BLU	15	RED/BLU ²
3	RED	16	---
4	BLK/RED	17	GRY
5	ORN	18	YEL ²
6	YEL ¹	19	LT GRN ¹
7	GRN/BLK	20	LT GRN ²
8	RED/WHT (M/T) ^{*3}	21	PNK
9	BLU/RED	22	BRN ²
10	GRN/BLU	23	BLK ¹
11	WHT	24	BLK ²
12	GRN/RED	25	YEL/BLK
13	BLU	26	GRN/BLK

**C387 (ECM-D): M/T
(PCM-D): A/T**

21	19	17	15	13	11	9	5	3	1
22	20	18	16	14	12	8	4	2	

1	YEL/BLU	14	BLK/WHT
2	GRN/WHT ¹	15	RED/WHT
3	WHT ¹	16	WHT ²
4	RED/BLU ¹	17	RED/YEL
5	ORN/RED ^{*3}	18	RED/BLU ³
6	---	19	RED
7	---	20	BLU ^{*3}
8	BLU/YEL	21	YEL/WHT ¹
9	WHT/RED	22	YEL/WHT ²
10	---	23	GRN/WHT ²
11	RED/BLU ²	24	GRN/WHT ³

**C388 (ECM-B): M/T
(PCM-B): A/T**

15	13	11	9	7	5	3	1
16	14	12	10	8	6	4	2

1	---	9	BLU/GRN
2	BRN/BLK	10	BLU/YEL
3	RED	11	ORN/BLU ¹
4	GRY	12	WHT/BLU ¹
5	GRN ¹	13	ORN
6	GRN ²	14	WHT ²
7	LT GRN (A/T)	15	ORN/BLU ²
7	WHT ¹ (M/T)	16	WHT/BLU ²
8	BLU		

**C389 (ECM-C): M/T
(PCM-C): A/T**

11	9	7	5	3	1
12	8	6	4	2	

1	YEL/BLK	7	PNK (M/T)
2	YEL/RED	8	GRY/BLU ^{*3}
3	BLU/BLK	9	WHT
4	BLU	10	---
5	RED/BLU	11	BLK/WHT
6	GRN/BLK ^{*3}	12	GRY/YEL ^{*3}

C531

6	5	4	3	2	1
14	13	12	11	10	9

1	BLK/WHT	8	---
2	PNK	9	GRN/WHT
3	GRN/ORN	10	YEL
4	GRN/YEL	11	GRN/BLK
5	GRN/BLU	12	BLK
6	GRN/BLK	13	GRN/RED
7	BLK/YEL	14	GRN

NOTE: Different wires with the same color have been given a number suffix to distinguish them (for example, YEL/BLK¹ and YEL/BLK² are not the same).

○: Related to Fuel and Emissions System.

*¹: Canada model

*²: L, LS model

*³: GS model